

ARIA RAILING®

PRE-ASSEMBLED ALUMINUM RAILING



(844) 612-2742

ARIA
RAILING®

www.AriaRailing.com



ABOUT ARIA RAILING®

ARIA Railing® is dedicated to providing you with a low maintenance aluminum railing system that will look great for years. We manufacture high-quality premium powder-coated aluminum baluster railing systems for decks, and patios with low-maintenance living in mind. Our dedication to research and development has produced an easy to install, do-it-yourself railing system while meeting North American commercial and residential building codes.

ARIA's high-performance railings are made of durable lightweight aluminum with a long-lasting powder-coated finish to stay looking like new. You will be satisfied with your railing for years backed up with a 20-year limited warranty.

Additionally, ARIA Railing® strives to be good stewards of the environment and the quality of life of its employees by developing maintenance-free products, which are recyclable, and through our manufacturing process, waste is disposed of in a responsible manner.

WHY CHOOSE ARIA RAILING®?

The ARIA aluminum baluster railing adds a durable and contemporary look to any home or commercial property. With do-it-yourself construction on the rise, we have developed a simple, easy-to-install railings system.

- **CONVENIENT KITS**
For Fast and Easy Installation
- **HIDDEN FASTENER SYSTEM**
No Welds or Rivets
- **EASY INSTALLATION**
Minimal Tools Required
- **BEAUTIFUL & DURABLE**
Architectural Grade Powder Coat Finish
- **LOW MAINTENANCE**
No Rusting, Cracking, Peeling, or Repainting
- **ENGINEERED & TESTED**
Commercial and Residential Approved
- **COMMERCIAL GRADE RAILING**
Meets Multifamily ICC-ES Criteria

WHAT YOU NEED TO GET STARTED:



Post Kit



Railing Kits with
included Hardware

PANELS CAN BE CUT TO FIT

FOR INSTRUCTIONS & VIDEOS
VISIT WWW.ARIARAILING.COM



CONVENIENT KITS

FOR MULTI-FAMILY, RESIDENTIAL
& COMMERCIAL USE

PANELIZED SYSTEM

FOR EASY ESTIMATING & INSTALLATION

AMMA 2604 ARCHITECTURAL COATING

HIDDEN FASTENERS

NO WELDS OR RIVETS

3 EASY STEPS



PLAN YOUR
PROJECT



SELECT YOUR
KITS



INSTALL YOUR
RAILING



BLACK



WHITE



BRONZE



PIANO

4 COLOR OPTIONS

ARCHITECTURAL GRADE POWDER COAT

Our products have a long-lasting AMMA 2604 textured powder-coated finish available in 4 different colors that won't fade, chip, or weather.

RAILING SPECIFICATIONS

- 6' Panels - Actual Sizes: 33.1618"H X 69.43" or 38.7318"H X 69.43"
- 8' Panels - Actual Sizes: 33.1618"H X 91.31" or 38.7318"H X 91.31"
- Balustrade Dimensions = 1/2" x 3/4" (.055" wall)
- Balustrade Spacing = 3.875"
- Top Rail - 2" x 1.92" (.050" wall)
- Bottom Rail - 1 1/2" x 1 1/2" (.050" wall)
- 3" x 3" x 36" Post - Actual Length: 38.25" (.065" wall)
- 3" x 3" x 42" Post - Actual Length: 43.5" (.065" wall)
- 3" x 3" x 48" Post - Actual Length: 49.5" (.065" wall)
- Support Leg Dimensions: 1.50" x 1.50" x 3.863" OA. This has a notch at 3.363", so from the resting surface to the bottom of the bottom snap is 3.363"

TOP RAIL PROFILE



ARIA RAILING® PRE-ASSEMBLED ALUMINUM RAILING

BALUSTER PANELS & POST KITS



BALUSTER RAILING PANELS

ARIA 36" x 6' Baluster Panel

(actual length 69.43")

Black: A366PPB-6
White: A366PPW-6
Bronze: A366PPZ-6
Piano: A366PPP-6

ARIA 36" x 8' Baluster Panel

(actual length 91.31")

Black: A366PPB-8
White: A366PPW-8
Bronze: A366PPZ-8
Piano: A366PPP-8

ARIA 42" x 6' Baluster Panel

(actual length 69.43")

Black: A366PPB-42
White: A366PPW-42
Bronze: A366PPZ-42

ARIA 42" x 8' Baluster Panel

(actual length 91.31")

Black: A368PPB-42
White: A368PPW-42
Bronze: A368PPBZ-42



STAIR PANELS

ARIA 36" x 6' Stair Panel

(actual length 69.43")

Black: A366SPB-6
White: A366SPW-6
Bronze: A366SPZ-6
Piano: A366SPP-6

ARIA 36" x 8' Stair Panel

(actual length 91.31")

Black: A366SPB-8
White: A366SPW-8
Bronze: A366SPBZ-8

ARIA 42" x 6' Stair Panel

(actual length 69.43")

Black: HDRBKSP426
White: A426SPW-6
Bronze: A426SPZ-6



3" POST/BASE KITS

ARIA 36" Post/Base Kit

(actual length 38.25")

Black: A36PBKB
White: A36PBKW
Bronze: A36PBKZ

ARIA 42" Post/Base Kit

(actual length 45.3")

Black: A42PBKB
White: A42PBKW
Bronze: A42PBKZ

ARIA 48" Post/Base Kit

(actual length 48")

Black: A48PBKBK-48
White: A48PBKWT-48
Bronze: A48PBKBZ-48

IMPORTANT NOTE:

- 42-inch post kits are required for middle/bottom stair posts when installing a 36-inch system
- 48-inch post kits are required for middle/bottom stair posts when installing a 42-inch system
- Fasteners are not included and are sold separately. Recommended fasteners can be found on page 15

ARIA RAILING® PRE-ASSEMBLED ALUMINUM RAILING

GATE & ATTACH KITS



GATE KITS

ARIA 36"x 40" Gate Kit

Black: AGKB
White: AGKW
Bronze: AGKZ

Kits include gate, self-closing hinges and keyed latching hardware.

ARIA 36"x 48" Gate Kit

Black: AGBKIT4836
White: AGWKIT4836
Bronze: AGBZKIT4836

ARIA 42"x 48" Gate Kit

Black: AGBKIT4842
White: AGWKIT4842
Bronze: AGBZKIT4836



RAIL CLIP JIG/TOUCH-UP PAINT

Black: ARCJPKB
White: ARCJPKW
Bronze: ARCJPKZ

Ensures proper placement of the lower rail clips when attaching to posts.

Touch-up paint is included for use when cutting extrusions.



STRAIGHT WALL MOUNT KIT

Black: ASWMAKB
White: ASWMAKW
Bronze: ASWMAKZ

Used to secure deck panels to structural surface without a post for support.



DECK PANEL ATTACH KIT

Required when deck panel is cut and attaching more than one section.

All Colors: ADPAK



STAIR PANEL ATTACH KIT

Required when stair panel is cut and attaching more than one section.

All Colors: ASPAK

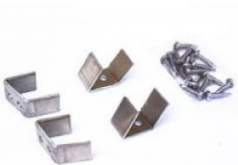

22.5° PANEL ATTACH KIT

Required for 45° deck corners. Refer to installation instructions for proper post placement.

All Colors: A225DPKIT



45° WALL MOUNT KIT

Required for 45° wall applications. Not to be used for post applications.

All Colors: A45DMK

ARIA RAILING® PRE-ASSEMBLED ALUMINUM RAILING

SOLAR LIGHTS



The modern yet elegant ARIA Railing® Solar Lights offer a clean contemporary ambiance that is unparalleled in performance. Manufactured with the same heavy duty, weather resistant, powder coat finished in three colors, designed to perfectly fit the 3" - ARIA Railing® posts. The solar charged battery and LED's will cast magnificent warm lighting accents for many years of maintenance free reliability. These stunning fixtures are the perfect addition to elevate your ARIA Railing® aluminum deck railing.



SOLAR LIGHTS

Black: LSO45310BK
White: LSO45310WT
Bronze: LSO45310BZ

ARIA RAILING® PRE-ASSEMBLED ALUMINUM RAILING

ADA HANDRAILS

ARIA offers easy-to-install ADA railing options that will seamlessly integrate into all ARIA Railing® systems. ADA handrails can be installed using various design applications such as those for stairs, ramps, and horizontal railings. Designs include options for straight and 90-degree wall returns, 90-degree corners, and adjustable angles. Installation of the ADA Handrails does not require any special tools.



The ADA Pipe Rail and Return Kit include everything needed for a straight/angled handrail measuring 94 inches long.

ADA PIPE RAIL & 90° RETURN KIT

Black: AADAPRBK
White: AADAPRW
Bronze: AADAPRBZ

Kit includes:
1 - 94" Pipe
2 - 90° Returns
2 - 90° Return Covers
2 - Post Backer Plates
2 - Joiner Rings
6 - #10 x 1½" Tek Screws
4 - #8 x ¾" Color Matched Tek Screws
Installation Instructions



The ADA Pipe Rail Extension Kit is used to add up to 94-inch to an ADA Pipe Rail and Return Kit.

ADA PIPE RAIL EXTENSION KIT

Black: AADAPEXBK
White: AADAPRW
Bronze: AADAPEXW

Kit includes:
1 - 94" Pipe
2 - 6" Joiners
2 - Joiner Rings
2 - Rail Support Brackets with adapters
2 - Post Backer Plates
2 - Support Bracket Caps
2 - #14 x 1½" Tek Screws
8 - #8 x ¾" Color Matched Tek Screws
Installation Instructions



The ADA Handicap Loop Kit adds a u-shaped extension to the base of a stair application for added safety.

ADA HANDICAP LOOP KIT

Black: AD901104B

Kit includes:
2 - Handicap Loops
2 - Rail Support Brackets with adapters
2 - Adjustable Elbows
2 - Post Backer Plates
12 - #8 x ¾" Tek Screws
2 - #14 x 1½" Tek Screws
Installation Instructions



ARIA RAILING® PRE-ASSEMBLED ALUMINUM RAILING

REPLACEMENT PARTS

The ARIA Railing® deck panels, stair panels and posts kits are designed to provide a comprehensive solution for your railing needs, including all essential components required for installation.

These kits come complete with top and bottom rails, balusters, brackets, and necessary hardware, ensuring you have everything needed to assemble a sturdy and attractive railing system.

The items listed below are included in the kits. These parts are only intended as replacement for those that may be damaged or misplaced during installation or use.

This ensures that you can easily maintain and repair your railing system without the need to purchase an entirely new kit, providing both convenience and cost-efficiency.

REPLACEMENT TOP AND BOTTOM RAIL SNAPS



ARIA 6' Top Snap

Black: ATRB6-6
White: ATRW6-6
Bronze: ATRBZ6-6

ARIA 8' Top Snap

Black: ATRB8-8
White: ATRW8-8
Bronze: ATRBZ8-8



ARIA 6' Bottom Snap

Black: BSB6-6
White: BSW6-6
Bronze: BSBZ6-6

ARIA 8' Bottom Snap

Black: BSB8-8
White: BSW8-8
Bronze: BSBZ8-8

REPLACEMENT POST CAPS

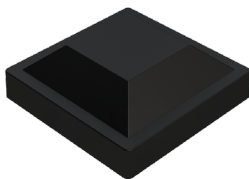

Black: PCB-3
White: PCW-3
Bronze: PCBZ-3

REPLACEMENT POST BASE COVER

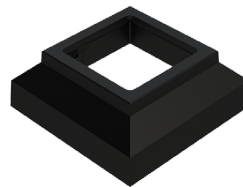

Black: VSB-3
White: VBW-3
Bronze: VSBZ-3

REPLACEMENT SUPPORT LEG



Black: DIKB
White: DIKW
Bronze: DIKZ



Need a Free Estimate?

Download
a Planning
Guide

Take your
measurements
and upload
drawings



Plan and price your railing system

 ariarailing.com/estimate



ARIA RAILING® PRE-ASSEMBLED ALUMINUM RAILING DECK PLANNER

****CONCRETE APPLICATIONS****

WHEN POSTS ARE SECURED TO CONCRETE SUBSTRATES USE TAPCON® 5/16" X 3" HEX WASHER HEAD CONCRETE ANCHORS (SOLD SEPARATELY)

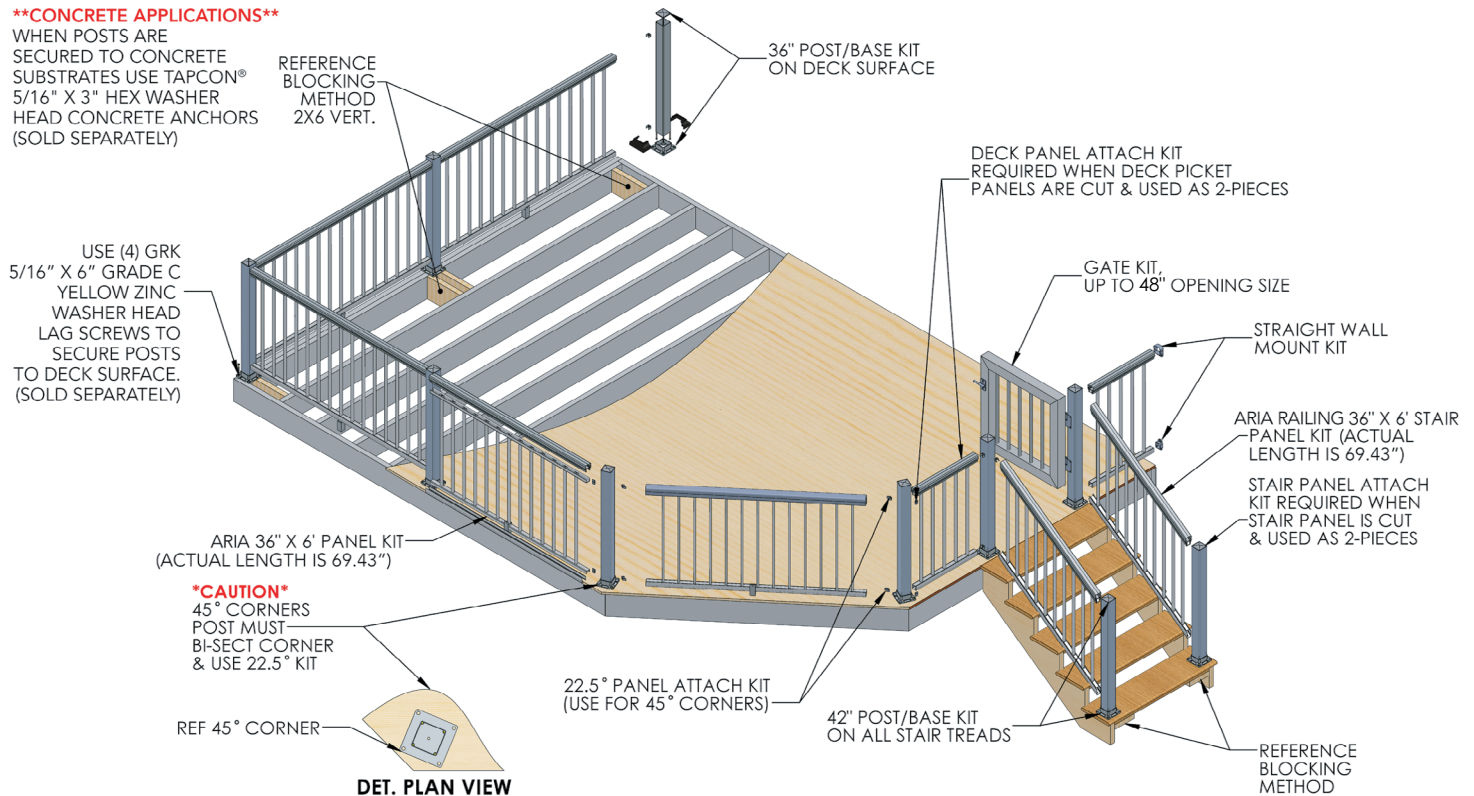

NEED AN ESTIMATE FOR YOUR NEXT PROJECT?

Our team is ready to help identify exactly what you'll need for your next railing update. Simply provide us with information about your project and an Aria Railing® representative will reach out to you. To help with the estimate process, please complete the following steps:

Step 1: Measure – To provide you with an accurate quote for our railing, we will need you to measure your deck and stairs. Be sure to measure every angle and document your measurements in feet and inches to the nearest 1/8". You will be providing these precise measurements to us.

Step 2: Create A Drawing of Your Deck – Now that you have your deck measurements, draw the shape your deck and indicate which side has which measurement. Label your measurements with a corresponding letter making sure to designate all measurements.

Step 3: Submit Your Estimate Request – Next, we will need you to send us all of the information you just collected. Please complete the form online at [AriaRailing.com/estimate](https://www.AriaRailing.com/estimate) or call us at (844) 612-2742 to submit your request.

Submit an estimate
request online at

AriaRailing.com

and our team will help
you plan your project.

**Request An
Estimate Online**

**Download the
Planning Guide**

ARIA RAILING® PRE-ASSEMBLED ALUMINUM RAILING INSTALLATION INSTRUCTIONS

Prior to construction, check with your local regulatory agency for special code requirements in your area.

Common railing height is 36" or 42". Never span posts more than 8' on center for baluster railing systems.

Always ensure there is proper blocking under each post as per diagram above and as per installation instructions.

Read installation instructions and view installation videos to get a complete understanding of how the ARIA products assemble.

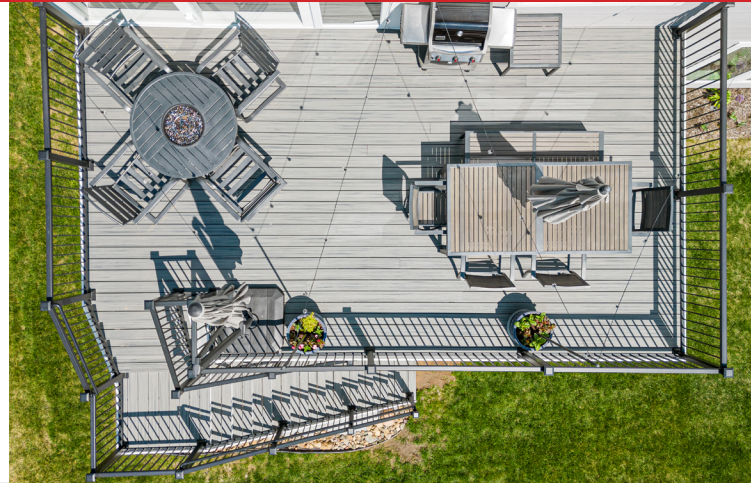

IMPORTANT NOTES:

- Actual baluster panel sizes: 6' Panels = 69.43"; 8' Panels = 91.31".
- 3" posts are required to reach 6' & 8' lengths.
- Do not install post base plate cover until railing assembly is completed.
- Maximum post spacing on deck for baluster railing is 8' on center.
- Maximum post spans on stairs for stair railing applications is 70" on center for 6' stair panels.
- Maximum post spans on stairs for stair railing applications is 91" on center for 8' stair panels.
- Stair railing panels are shipped at a 37° angle. Panels are adjustable and will accommodate 30-40° stair angles. CAUTION: Over adjusting stair panels will cause loose and rattling balusters.
- 45° deck angles require 22.5° clips applied to each side of the post. The 22.5° clip kit is sold SEPARATELY.
- Two 3" posts are recommended on top of deck surface if stair riser is not at a 90° angle from deck frame.

Installation Instructions
& Videos
can be found
online at

AriaRailing.com

[View Installation Videos](#)

[Download Instructions
in Spanish](#)

HOW TO INSTALL ARIA RAILING® POSTS & BALUSTER RAILING PANELS

STEP ONE - DETERMINE NECESSARY POSTS REQUIRED & PREPARE (end, center or corner)

Install Lower Deck Rail Clips - Two Options:

OPTION A -

When No Lower Rail Clip Jig Is Available

- Measure 2 7/8" from top of casting shoulder and place a pencil mark for location of the top edge of the rail clip. (DIA. #1)

- Center clip on post and secure with (2) - #8x3/4" TEK screws.

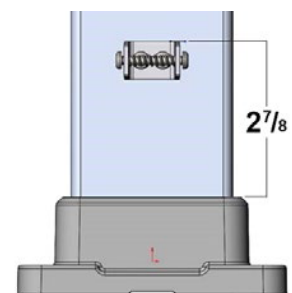

(DIA. #1)

OPTION B -

Using Lower Rail Clip Jig

- Place lower rail clip jig (w/arrow facing base plate) on top of base plate upper edge. (DIA. #2)
- Place clip in hole and fasten with (2) - #8x3/4" TEK screws.

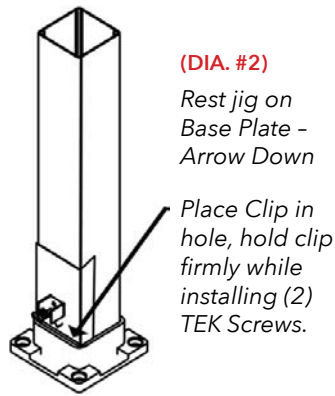

STEP TWO - SECURING POSTS TO DECK

Install proper post blocking as per (DIA. #3). Use proper attachment screws or anchors as directed below. (Deck screws at each post location, are not provided with kits).

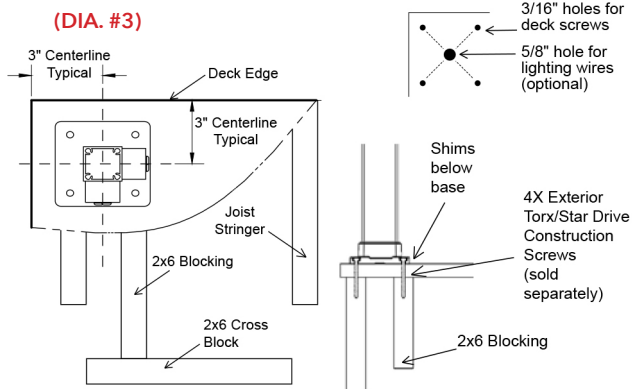

- With 3/16" drill bit, pre-drill through deck boards and into blocking.
- Level and plumb post using shims.
- Secure posts to deck with suggested screws.
- Install post cap and post base vinyl plate cover AFTER railing assembly is completed. (DIA. #4)

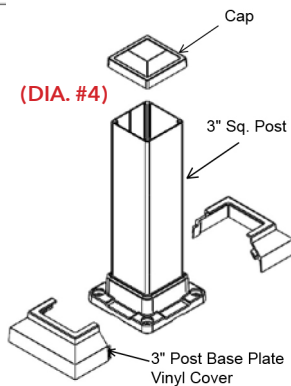

STEP THREE - CUT DECK PANELS

- Clamp or hold panel against post, adjust for equal end spacing. (DIA. #5)
- Mark the top and bottom rails.
- Cut panel 1/16" less than opening size.
- Clean cut areas and apply touch-up paint on

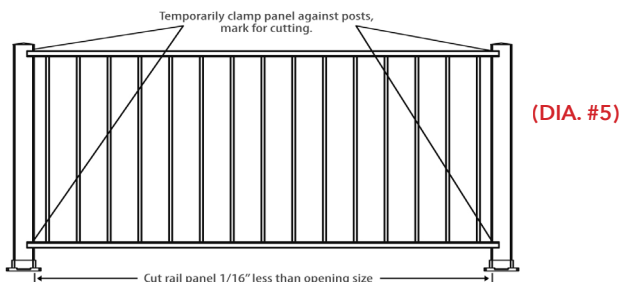

STEP FOUR - SECURE DECK PANELS TO POSTS

- Slide bottom channel of pre-cut panel on to lower clip. (DIA. #6)
- Insert clips into top channel of panel on each end.
- Using (4) - #8x3/4" TEK screws, attach the upper 2-clips to the post.
- Using (8) - #8x3/4" TEK screws, secure the upper and lower clips to the panel.

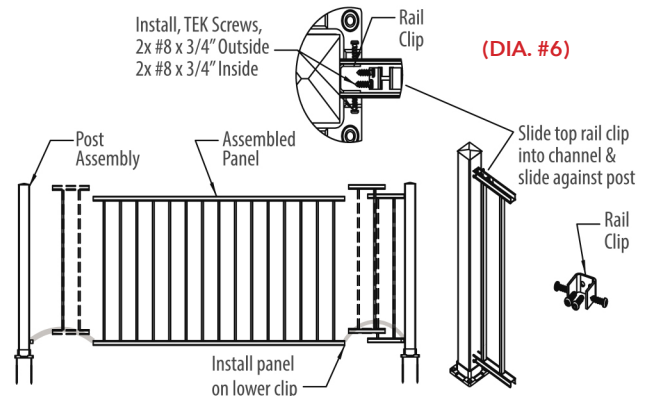

STEP FIVE - CUT AND INSTALL TOP AND BOTTOM RAIL SNAPS

- Measure between posts at the top and bottom. (DIA. #7)
 - Cut top and bottom snap covers 1/16" less than opening.
 - Clean cut areas and apply touch-up paint on all exposed metal.
 - Snap each rail snap over the corresponding rail channel until properly seated. (DIA. #8)
- TIP: If snap will not seat, try installing support leg. Then apply pressure to snap starting from one end.

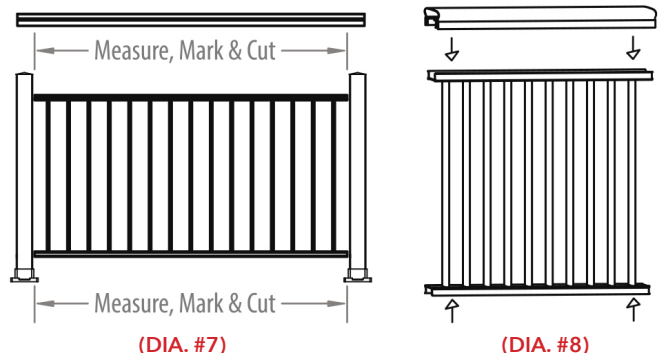

To install Stair Panels and/or Gate Kits,
CONTINUE ON NEXT PAGE →

If this concludes your installation,
CONTINUE TO FINISHING INSTRUCTIONS →

HOW TO INSTALL ARIA RAILING®

STAIR RAILING PANELS & ADA HANDRAILS

STEP ONE - FITTING STAIR RAILINGS

- Hold or temporarily clamp stair panel against posts and
- Adjust for equal end spacing. (DIA. #9)
- TIP: lay a 2"x4" board flat on nose of stair treads. This will allow enough room for installation of bottom snap.
- Mark the stair channels at four (4) locations of post connections.
- Remove clamps and miter cut stair panel at all four (4) locations, cutting rail 1/16" less than opening.
- Clean cut areas and apply touch-up paint on all exposed ends.

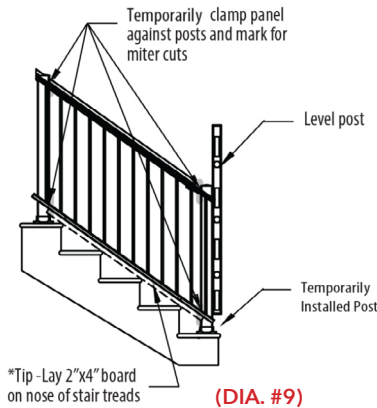

- 3" posts. (DIA. #10)
- Mark the top/bottom rail snaps at all four (4) locations.
- Remove clamps and cut top/bottom rail snaps at all marked locations. Take care to cut snaps at appropriate stair angle. Use of Miter saw with a sharp non-ferrous blade is recommended. Cut 1/16" less than opening size.
- Clean cut areas and apply touch-up paint on exposed ends.
- Snap each rail snap over the corresponding rail

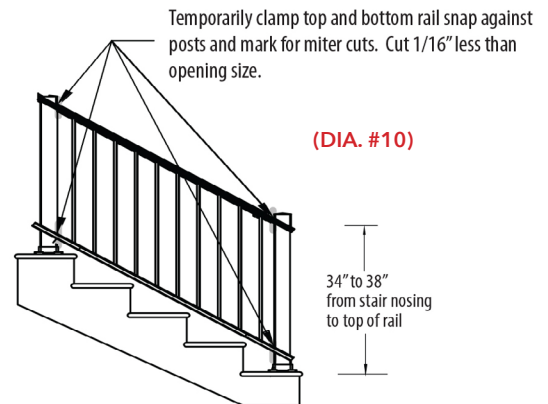

STEP TWO - INSTALLING STAIR CLIPS ON POSTS

- Next, place the panel on the 2"x4" (or hold 1 1/2" above stair nosing) board, between the 3" posts, and mark posts for location of lower rail clips.
- Remove panel then install lower stair rail clips at marked location and fasten with #8x3/4" Tek screws.

STEP THREE - SECURING STAIR PANEL TO POSTS

- Place cut stair panel between posts onto the lower stair rail clips.
- Insert clips into top channel of panel on each end.
- Using (4) - #8x3/4" TEK screws, attach the upper 2-clips to the post.
- Using (8) - #8x3/4" TEK screws, secure the upper and lower clips to the panel. (DIA. #6 – PREVIOUS PAGE)

STEP FOUR - INSTALL TOP & BOTTOM SNAP COVERS

- Following the same angle as the secured stair panel, clamp or hold top/bottom rail snaps against

channel until properly seated.

STEP FIVE - INSTALLATION OF ADA COMPLIANT HANDRAIL

ADA handrail may be required for residential deck installations (check with local building code official).

- Maximum recommended span between posts for ADA Handrail is 6' on center.
- Follow the basic diagram bellow (DIA. #11) and then download ARIA's ADA Handrail Installation Instructions at AriaRailing.com/install-instructions for all installation configurations.

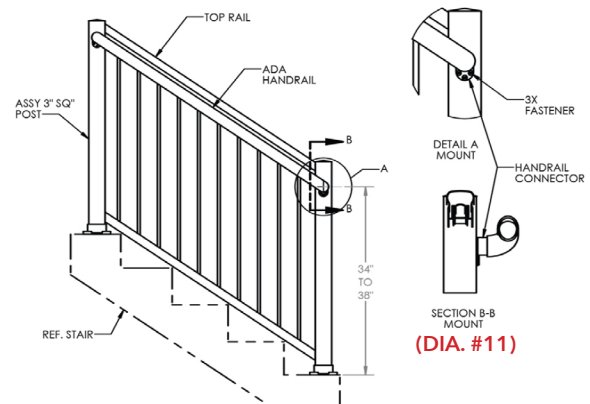

GATE KITS

STEP ONE - CUT GATE PANEL

- Measure gate opening between posts. (DIA. #12)
- Baluster Gate Panel (without Gate End Posts) must be exactly 4.5" less than gate opening.
- Deduct 4.5" from opening measurement and cut both panel ends, leaving equal baluster spacing. (DIA. #13)

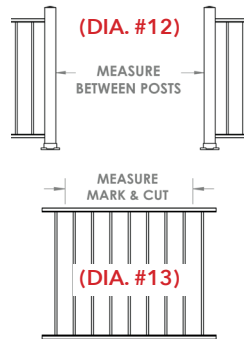

STEP TWO - INSTALL GATE END POSTS

- Insert Gate End Posts into panel upper and lower channels.
- Drill 16 - 1/8" holes as per diagram and install 3/4" TEK screws to secure gate ends to panel. (DIA. #14)

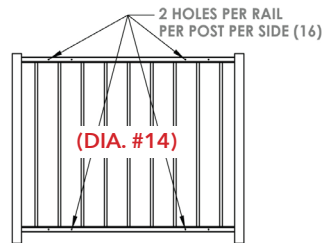

STEP THREE - INSTALL SNAP COVERS

- Measure between Gate End Posts, deduct 1/16", cut top/bottom snap covers, and press in place.

STEP FOUR - ADD SUPPORT BRACKETS

- Attach Support Bracket to Post using 2x #8 x 3/4" TEK screws as shown, then press Support Bracket against Horizontal Rail, drill 2x 1/8" pilot holes and secure using remaining 2x #8 x 3/4" TEK screws. Repeat for remaining brackets. (DIA. #15)

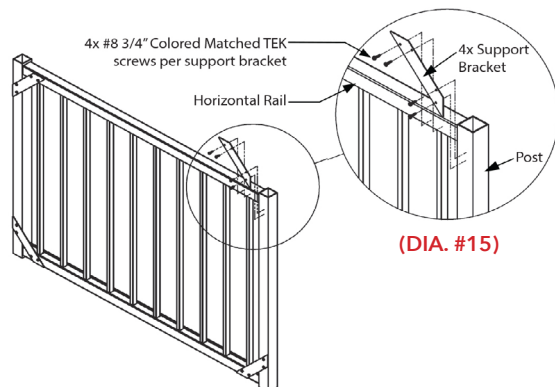

STEP FIVE - INSTALL HINGES & LATCH

- Follow the instructions provided in the hinge and latch packages included with your gate kit.

HOW TO INSTALL ARIA RAILING® FINISHING INSTRUCTIONS

INSTALL SUPPORT LEGS

- For openings greater than 4', install support legs under center of bottom rail. (DIA. #16)
- Slide support leg under bottom rail and mark. (DIA. #16)
- Install two deck screws at location of support leg, install support leg over screws. (DIA. #17)
- Using (1) - #8x3/4" TEK screws, secure the support leg to bottom rail. (DIA. #17)

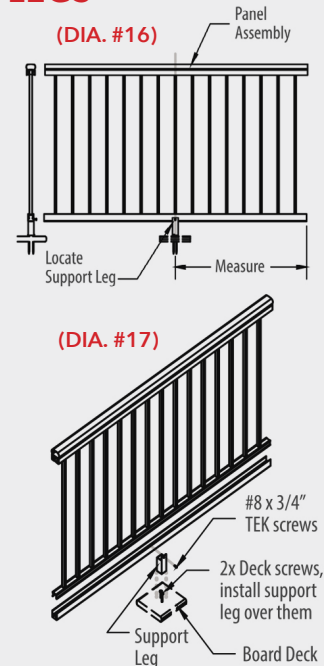

INSTALL ADA COMPLIANT HAND RAIL

- ADA handrail may be required for residential deck installations. Check with local building code officials. (DIA. #18)
- Maximum recommended span between posts is 6' on center.
- See Aria Railing's ADA Railing Installation Instructions for all installation configurations.

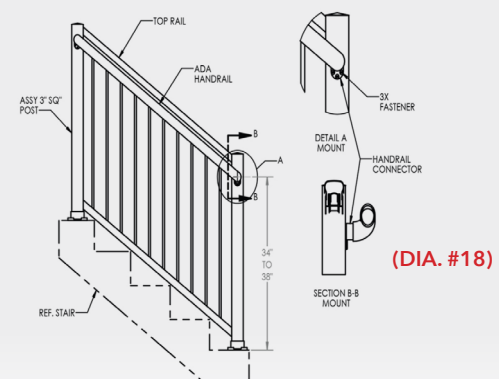

Installation Instructions & Videos
can be found online at

AriaRailing.com

ARIA RAILING® PRE-ASSEMBLED ALUMINUM RAILING

RECOMMENDED TOOLS & HARDWARE



Cordless Drill
(Hammer Drill
for Concrete)



Level



Tape Measure



Bar Clamp



Miter Saw
(with nonferrous
blade)



**84 Tooth
Nonferrous
Blade**



**6" #2 Square
Drive Bit**



3/16" Drill Bit



**14" Tapcon
Drill Bit
(for Concrete)**



Pencil



Safety Glasses

WOOD OR COMPOSITE DECKING



GRK® RSS™ 5/16" x 6"
Grade C Yellow Zinc
Washer Head
Structural Screw

Residential
applications only.

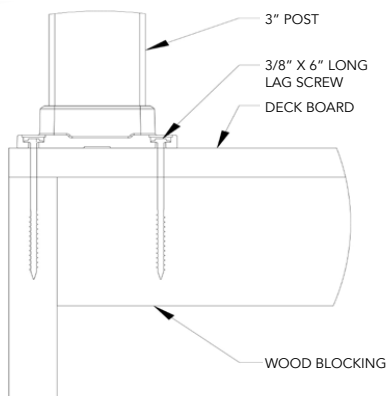

CONCRETE APPLICATIONS



Tapcon® 5/16" x 3"
Hex Washer Head
Concrete Anchor

Residential
applications only.

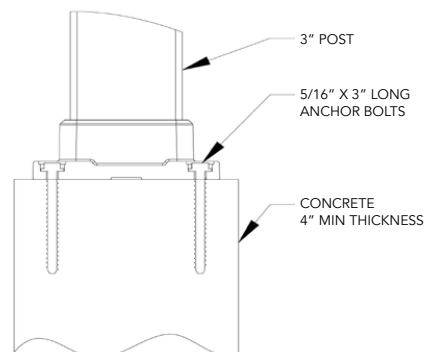

FREQUENTLY ASKED QUESTIONS

ICC-ES CERTIFIED SAFETY PRODUCT TESTING

1. What kind of railing systems does ARIA Railing® offer? ARIA Railing® railing systems consist of pre-assembled aluminum balustrade panels made at 69.43" and 91.31" in length. Panels span 6' and 8' on center when installed with 3" posts.

2. What colors are available? ARIA Railing® offers a durable AAMA 2604 textured powder-coated finish available in Black, White, Bronze, and Piano (white w/black infill).

3. Is the hardware to install the railing inside the deck and stair panels? Yes, there is one (1) set of attachment clips to attach each end to a ARIA Railing® post. If the deck or stair panels are cut into two (2) pieces, then an additional attachment kit would be necessary.

4. What if my deck has a 45° corner? A 22.5° kit must be purchased separately. The 3" post must be turned so that the top/bottom rails attach to the post at a 22.5° angle.

5. Can I cut the top rail at 45° angle? Only if coming directly off the building at 45°; then a separate 45° angle kit must be purchased. The standard 3" posts will not accommodate a 45° cut top/bottom rail.

6. What type of saw do I use to cut the metal? The best saw is a 10" miter saw with a 10" 84-tooth (or more) nonferrous saw blade. If a nonferrous blade is not available, high tooth-count carbide saw blade will suffice. Most important is to use a sharp saw blade!

7. Why don't you supply the fasteners to secure the posts to the deck surface? We have no way of knowing to what type of deck surface the railing will be mounted. Therefore, fasteners are sold separately.

8. What are the recommended fasteners to secure the posts to the deck surface? For residential applications only, we recommend 5/16" x 6" Grade C Yellow Zinc Washer Head Structural Screws for all posts. For concrete applications, we recommend 5/16" x 3" Hex Washer Head Concrete Anchors.

9. What if the top snap will not stay secured on the H-channel? Remove the top snap from the H-channel. Pre-drill three holes in the bottom of the H-channel: one hole on each end and one in the center. (Use a drill bit slightly smaller than the screw size to ensure it's snug but not too tight.) Press the top snap back onto the H-channel and secure. If needed, use C-clamps to hold the top snap firmly in place while drilling.

Click To View The
Full ICC-ES Safety Report



We know for you and your loved ones, safety needs to be the top priority - and here at ARIA Railing®, it is. That's why our railing is extensively tested for every situation and is backed with an ICC-ES Evaluation.

WHAT IS AN ICC-ES EVALUATION?

ICC Evaluation Service (ICC-ES) is the industry leader in performing technical evaluations of building products, materials and systems for code compliance. Due to its diligence and unparalleled engineering experience, ICC-ES is the most widely accepted evaluation agency in the nation.

WHAT DOES THIS MEAN FOR YOU?

With these high standards, this means that our products have been rigorously tested, giving you peace of mind in the highest quality and ensure safety with every proper installation.

COMMITMENT TO TESTING AND SAFETY TRANSPARENCY

These reports are regularly updated and always shared with our customer because we back up our promise to the highest quality and customer service standards.

READ THE ARIA RAILING® ICC-ES EVALUATION

Have questions? No problem! Visit the Resources Section on AriaRailing.com to view the ARIA Railing® full ICC-ES Safety Report.

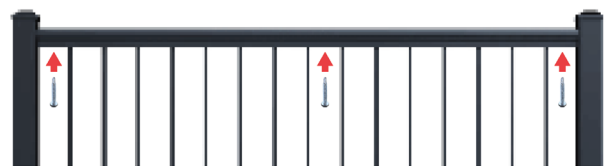

(9, cont.) Drive the screws through the pre-drilled holes in the H-channel and into the top snap. Repeat for all three holes. *Important: Do not over-torque the screws. Overtightening can snap the screw heads.*

ARIA RAILING® PRE-ASSEMBLED ALUMINUM RAILING

CLEANING & MAINTENANCE

BACKGROUND

ARIA Railing®, architectural powder coatings are organic coatings which must be regularly cleaned and maintained in order to ensure the decorative and protective properties of the coating are retained. Records of all cleaning schedules and frequencies shall be kept and maintained by customer according to the process outlined below and shall be available to ARIA Railing® upon request.

CLEANING METHOD

Usual maintenance of Products must adhere to the following steps:

- Clean using a warm water and a non-abrasive, pH neutral (pH 5 to 8) detergent solution. Do not use solvents such as thinners or solutions containing chlorinated hydrocarbons or ketones.
- If atmospheric pollution has resulted in heavy soiling of the Coating, some stains or marks may require stronger domestic products, such as alcohol, petroleum spirits, white spirits or bleach diluted to five percent (5%). In this instance, Customer must rinse the Coating immediately after using the cleaning
- All surfaces shall be cleaned using a soft cloth or sponge, and no cloth shall be harsher than natural bristle
- Cleaning agent must be rinsed immediately after application.
- If the Product is subject to any hazardous and unusual environmental factors or is located within one (1) mile of the seashore, an estuary or marine environments, ARIA Railing® must be consulted on an individual project basis for best maintenance practices.

FREQUENCY

Customer shall clean the Product according to the following frequencies:

- Two (2) times per year for all Products located within one (1) mile of the seashore
- The cleaning cycle shall commence within six (6) months of installation
- Cleaning shall be conducted in intervals not to exceed six (6) months
- Customer shall maintain fully documented records throughout the Warranty term
- One (1) time per year for all Products located more than one (1) mile of the seashore
- The cleaning cycle shall commence within twelve (12) months of installation
- Cleaning shall be conducted in intervals not to exceed twelve (12) months
- Customer shall maintain fully documented records throughout the Warranty term

ADDITIONAL FACTORS

- Damage from installation, mechanical processes, jig marks and other related defects must be repaired immediately in order for the Warranty to remain in effect.
- Protective tapes used in installation must be a "low tack" quality and must not be left in contact with the surface for more than one (1) month.
- ARIA Railing® must approve all sealants and mastics prior to installation in order for Warranty to remain in effect.
- To qualify for warranty, please follow the instructions on the following page.

ARIA RAILING® PRE-ASSEMBLED ALUMINUM RAILING

20-YEAR LIMITED WARRANTY

ARIA Railing® warrants its Railing products to be free from manufacturing defects in material and workmanship to the original consumer purchaser. In addition to manufacturing defects, this warranty covers cracking, peeling and blistering of the finish of our products.

This warranty does not cover damage caused by abnormal or improper use, improper product installation, accidents, alterations, welding, neglect, damage by lawn care equipment, abrasion, harsh chemicals, pool chemicals, snow/ice removal chemicals, air pollutants, improper or lack of service, damage caused by fire, flood or acts of God. This warranty does not cover corrosion from cuts, scratches, dents or nicks.

This warranty applies to all aluminum extrusions which have been supplied by ARIA Railing® which have AkzoNobel Interpon D2000 Super Polyester Architectural Powder Coating applied. AkzoNobel Interpon D2000 powder coating shall only be applied by approved Interpon D applicators with fully-operational Quality Management Systems. Qualified applicators must have written procedures and defined record keeping/documentation that covers the mandatory requirements set forth by AkzoNobel to ensure that the metal pre-treatment and powder application processes are carried out consistently and to the required AkzoNobel/AAMA 2604 Standards.

Products within 1 mile of any coastline do not qualify for any Aria Railing warranty.

Products in direct contact with saltwater do not qualify for any ARIA Railing® warranty.

The original customer purchaser must contact ARIA Railing® directly via phone at 844-612-2742 or via email at warranty@ultralox.com to obtain necessary warranty approval documents and instructions on how to file them. ARIA Railing® will notify the original consumer purchaser directly as to whether the claim has been approved or denied. All warranty claims must include the original proof of purchase receipt in order to be considered for approval.

CONDITIONS AND EXCLUSIONS:

CLEANING AND CARE INSTRUCTION AS PER EXHIBIT A MUST BE FOLLOWED.

THIS WARRANTY IS NOT TRANSFERABLE. THE AMOUNT OF RESTITUTION, IF ELIGIBLE, WILL NOT INCLUDE LABOR TO REMOVE THE EXISTING PRODUCT OR INSTALL ANY REPLACEMENT COMPONENTS, SHIPPING CHARGES, SALES TAX OR ANY OTHER CHARGES NOR WILL ARIA RAILING® PROVIDE SUCH LABOR OR SERVICE.

THIS LIMITED WARRANTY IS IN LIEU OF ALL OTHER EXPRESS WARRANTIES. ARIA RAILING® MAKES NO OTHER EXPRESS WARRANTIES AND DOES NOT AUTHORIZE ANY OTHER

PERSON OR AGENT TO MAKE ANY OTHER EXPRESS WARRANTIES. ARIA RAILING® NEITHER ASSUMES NOR AUTHORIZES ANY OTHER LIABILITY OR OBLIGATION IN WARRANTY, INCLUDING WITHOUT LIMITATION, THE IMPLIED WARRANTIES OF MERCHANTABILITY AND FITNESS FOR A PARTICULAR PURPOSE WITH RESPECT TO THEIR PRODUCTS. IN NO EVENT SHALL ARIA RAILING® BE LIABLE FOR ANY CONSEQUENTIAL, SPECIAL, OR INCIDENTAL DAMAGES ARISING OUT OF OR CONNECTED WITH THE PURCHASE OR USE OF THEIR PRODUCTS OR FOR ANY BREACH OF WARRANTY.

SOME STATES DO NOT ALLOW LIMITATIONS ON HOW LONG AN IMPLIED WARRANTY LASTS OR THE EXCLUSION OR LIMITATION OF INCIDENTAL OR CONSEQUENTIAL DAMAGES, SO THE ABOVE LIMITATIONS OR EXCLUSION MAY NOT APPLY TO YOU. THIS WARRANTY GIVES YOU SPECIFIC LEGAL RIGHTS AND YOU MAY HAVE OTHER RIGHTS THAT VARY FROM STATE TO STATE. THIS WARRANTY IS APPLICABLE ONLY TO SYSTEMS INSTALLED WITHIN THE CONTINENTAL UNITED STATES AND CANADA.



ARIA RAILING®

Visit **AriaRailing.com**
or Call **(844) 612-2742**

Find Us On:

